

SKUII Series USB Magnetic Card Reader

Feature

- Manual-swipe type reader
- Bi-directional reading capability
- ISO 7810, ISO 7811, JIS X6302 Type 1 & Type 2 conformance
- USB HID device (Human Interface Device)
- Simulating “keyboard” input
- Power supplied by PC USB port
- Operation responded by two LED and one buzzer
- Small size



Specification

Items		Contents		
ISO 7811, JIS X6302 Type 1	Track	Track 1	Track 2	Track 3
	Recording density	210 BPI	75 BPI	210 BPI
	Capacity	79 characters	40/107 characters	107 characters
	Bits Per Character	7	5	5
	Start / End Code	'%' / '?'	',' / '?'	',' / '?'
JIS X6302 Type 2	Recording density	210 BPI		
	Capacity	72 characters		
	Bits Per Character	8		
	Start / End Code	0x7F / 0x7F		
Card swiping speed		10 ~ 150 cm/sec		
Decoding method		F/2F		
USB		Compliant with USBV1.1		
Power		Power supplied by the computer		
Operation temperature		-10 ~ 50°c		
Life time of head		Approx. 300,000 passes		
Cable length		100 cm		
Operating System		Support Microsoft Windows 98 (2 nd Edition), ME, 2000, XP		
Keyboard Languages		English, Chinese, Portuguese, Spanish, Danish, Italian, French, German, Japanese		

Pin assignment

USB	
NO.	Signal
1	Vcc
2	-Data
3	+Data
4	GND

Dimension

Model NO.	Dimension (L×W×Hmm)
SKU90 Series	90×29×27mm

SKUII Series USB Magnetic Card Reader

Model description

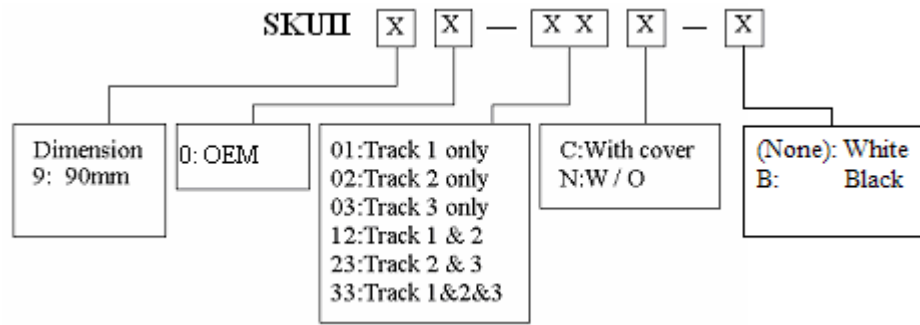

- White Cover



- Black Cover



SKUII Series USB Magnetic Card Reader

DIP Switch definition:

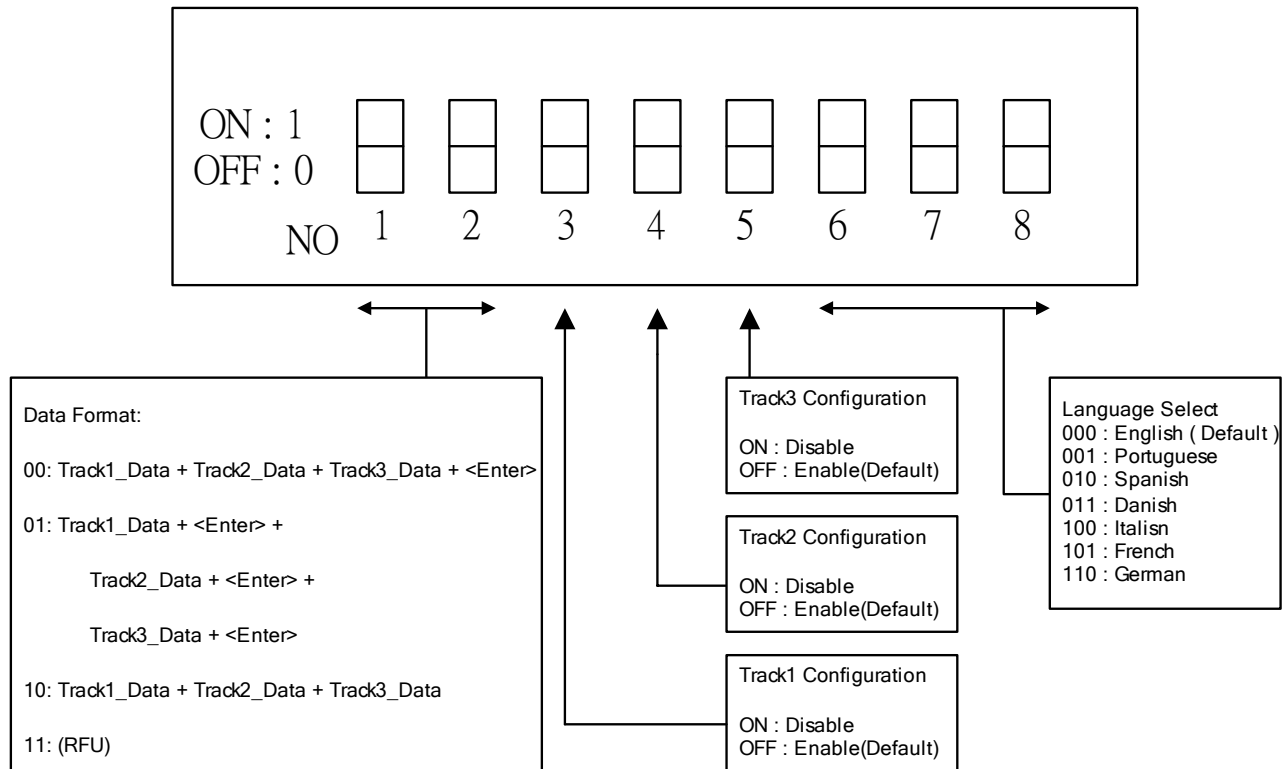

Data format:

- SW1 SW2 00

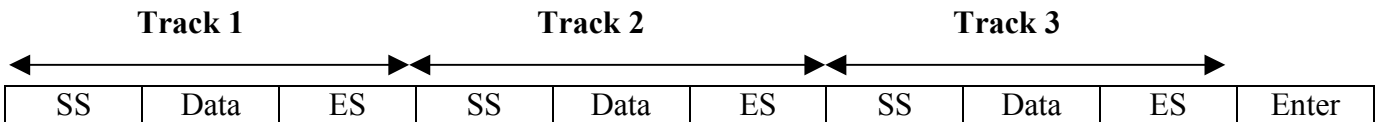

- SW1 SW2 01

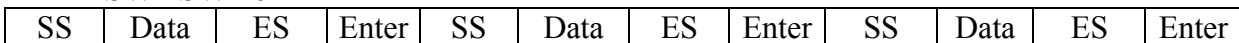

- SW1 SW2 10

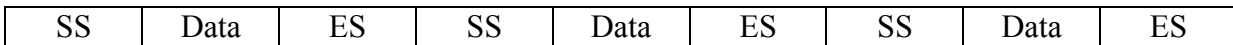

Notes:

- (1) SS: Start sentinel of ISO and JIS Type 1 T1=0x25 '%', T2 = T3 = 0x3B ';' ; SS of JIS Type 2 = 0x7F.
- (2) ES: End sentinel of ISO format T1/T2/T3=0x3F "?"; ES of JIS Type 2 = 0x7F.
- (3) Successful Result: The reader will make beep once.
- (4) Failed Result: If card data format is not following ISO-7811 standard or operation error, the reader will beep twice and the red LED will be turned on.
- (5) API Mode: Push DIP SWITCH 3、4、5 ON and it will change from HID mode to API mode. You can use the libraries (DLL and OCX) that you can find in product CD-ROM' SUII folder to control the reader.

SKUII Series USB Magnetic Card Reader

Dimension

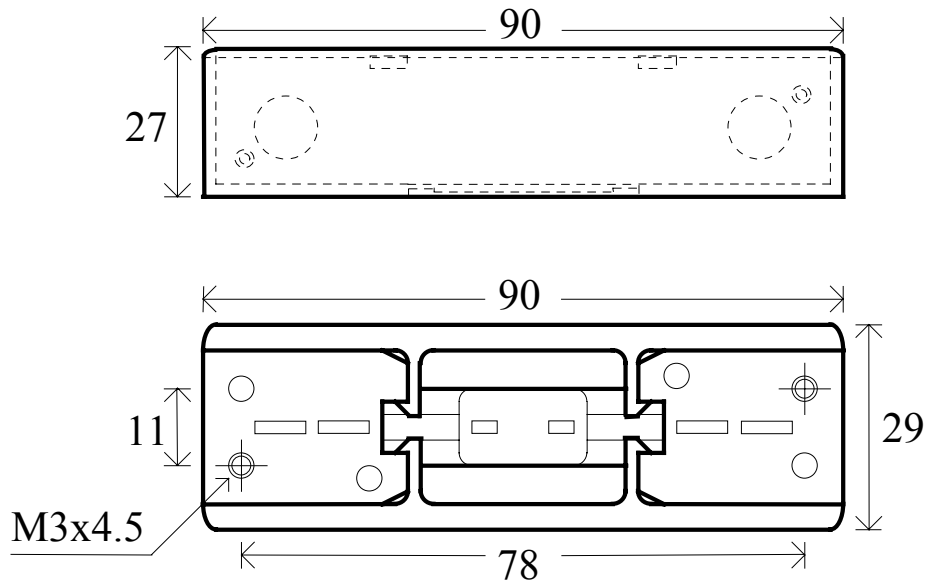

SKUII Series USB Magnetic Card Reader

Cable Specification: 1/2

P2 to SU-Series
JAE IL-Z-5S-S125C3 or compatible

P1 to USB
(Low-speed cables;
non spiral, non covered)

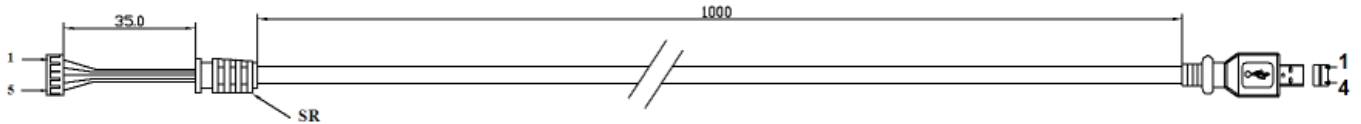

Unit: mm

Cable: 4C+1 28AWG

OD: 3.8 ± 0.1 mm

Pin assignment

Color	P1	P2	Function
Red	1	2	Vcc
White	2	3	Data -
Green	3	4	Data +
Black	4	5	GND
		1	Case GND

SKUII Series

USB Magnetic Card Reader

Cable Specification: 2/2

